

Silver Cross[®]

Canterbury Wardrobe

Assembly Instructions

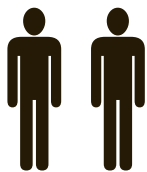
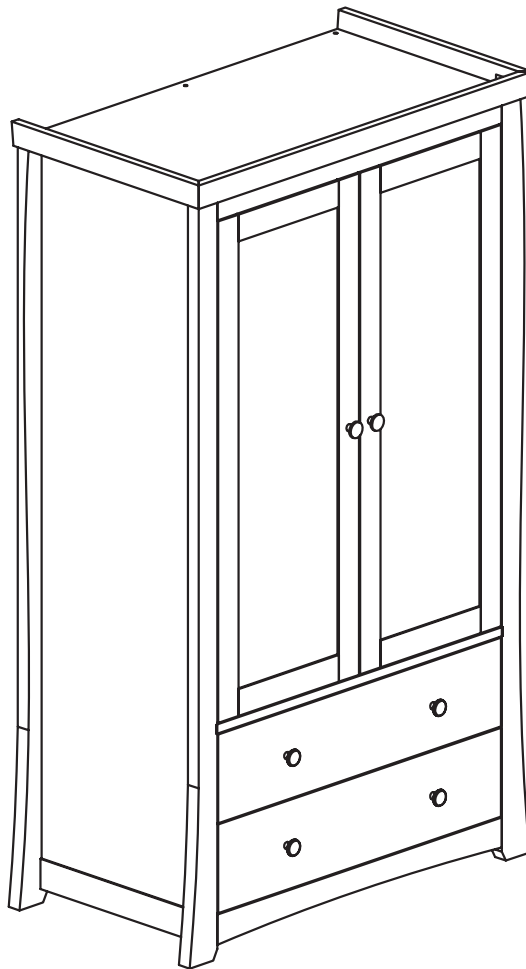

IMPORTANT:
THE ASSEMBLY OF THIS PRODUCT
REQUIRES TWO PEOPLE

IMPORTANT, RETAIN FOR FUTURE REFERENCE: READ CAREFULLY

Parts List:

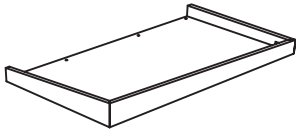

A = 1pc

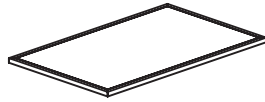

B = 1pc

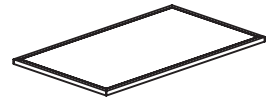

C = 1pc

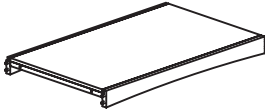

D = 1pc



E = 1pc (R)

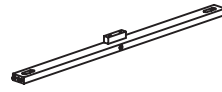

E1 = 1pc (F)



F = 1pc

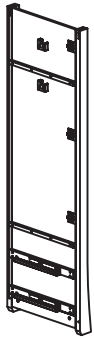

G = 2pcs (L&R)



H = 2pcs (L&R)

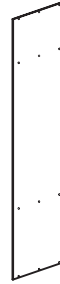

I = 2pcs (L&R)



K = 1pc

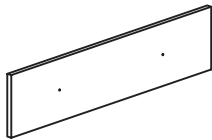

L = 2pcs

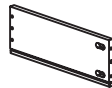

L1 = 4pcs (L&R)



L2 = 2pcs

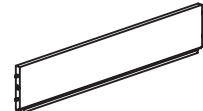

L3 = 2pcs

Fittings List:

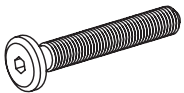

M (M6X35) = 28pcs

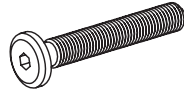

M1 (M6X40) = 4pcs

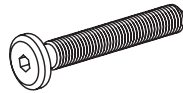

M2 (M6X60) = 2pcs

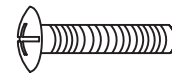

N = 6pcs



P (M4X25) = 4pcs



1 x PVC Bag



P1 (M4X15) = 28pcs



O (M4X20) = 4pcs

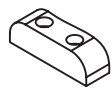

R = 2pcs

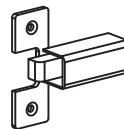

S = 4pcs



P2 (M4X20) = 8pcs

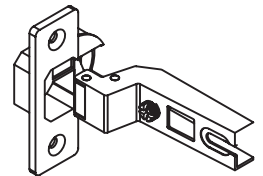

Q = 6pcs

1 x PVC Bag

1 x PVC Bag

P2 (M4X20) = 1pc



Z = 1pc



Y = 1pc



1 x PVC Bag



V = 12pcs



W = 6pcs



T = 1pc



X = 1pc

Step 1:

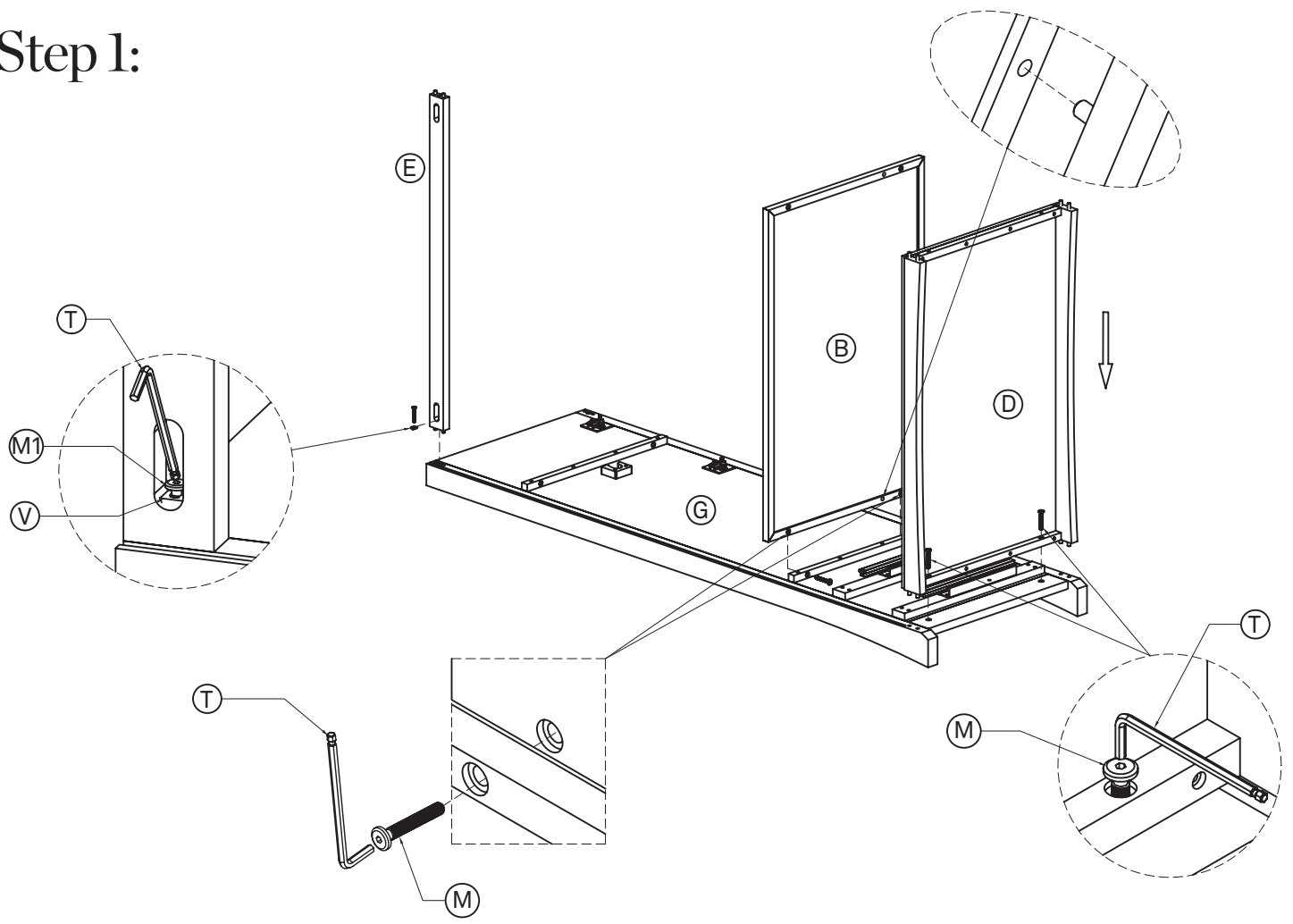

Step 2:

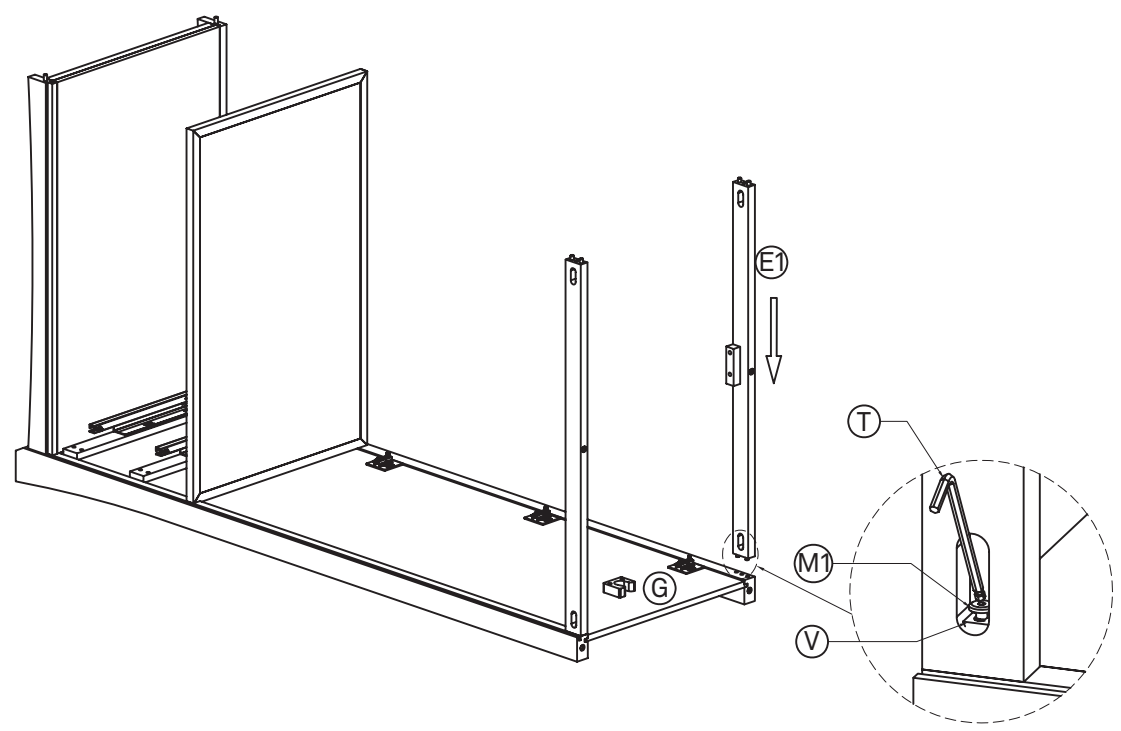

Step 3:

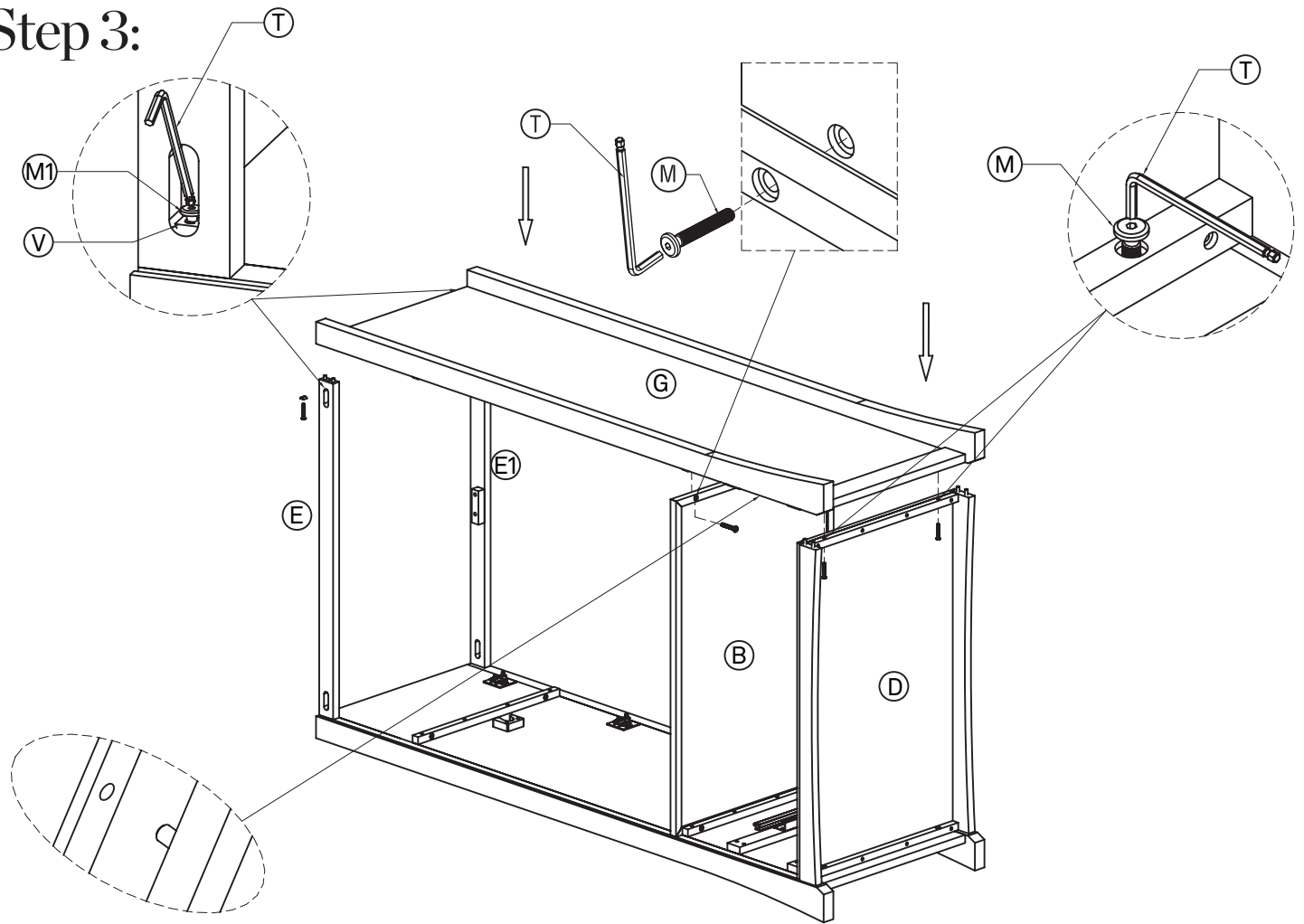

Step 4:

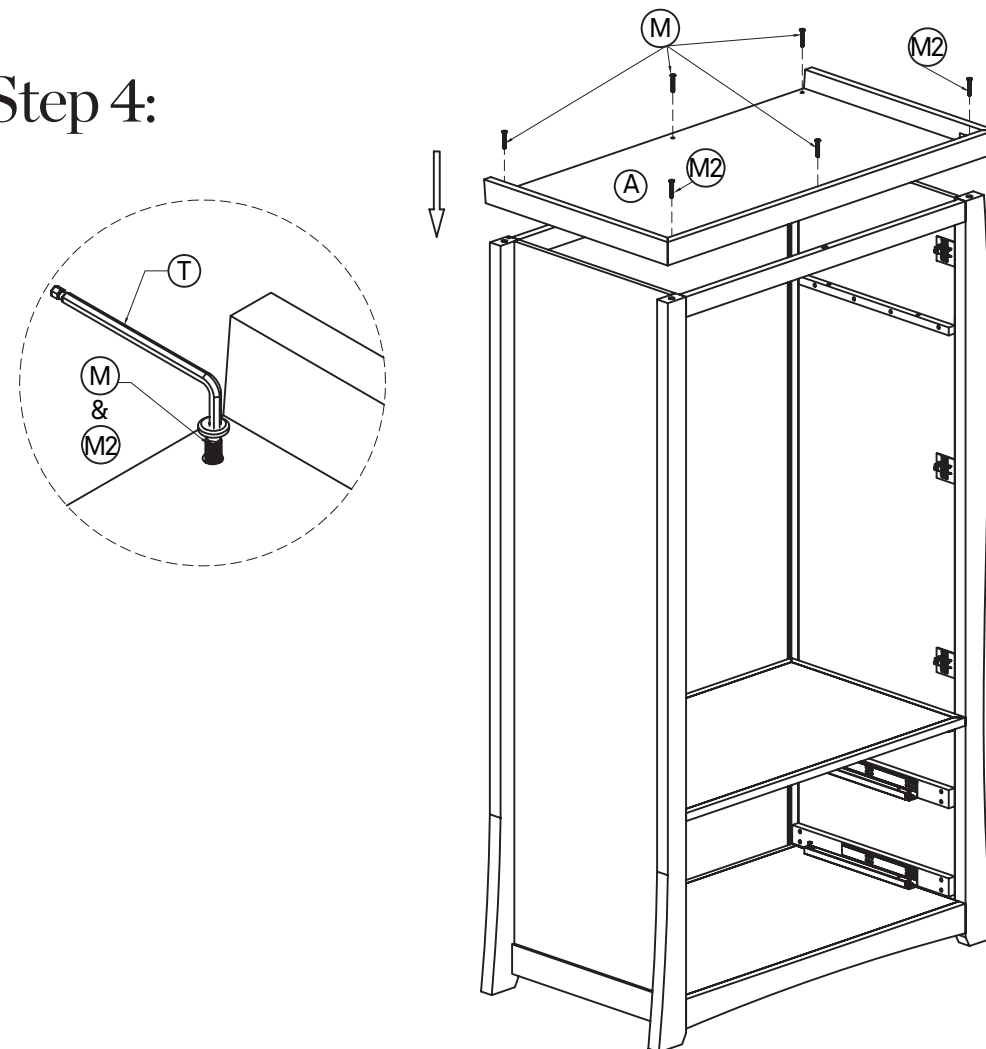

Step 5:

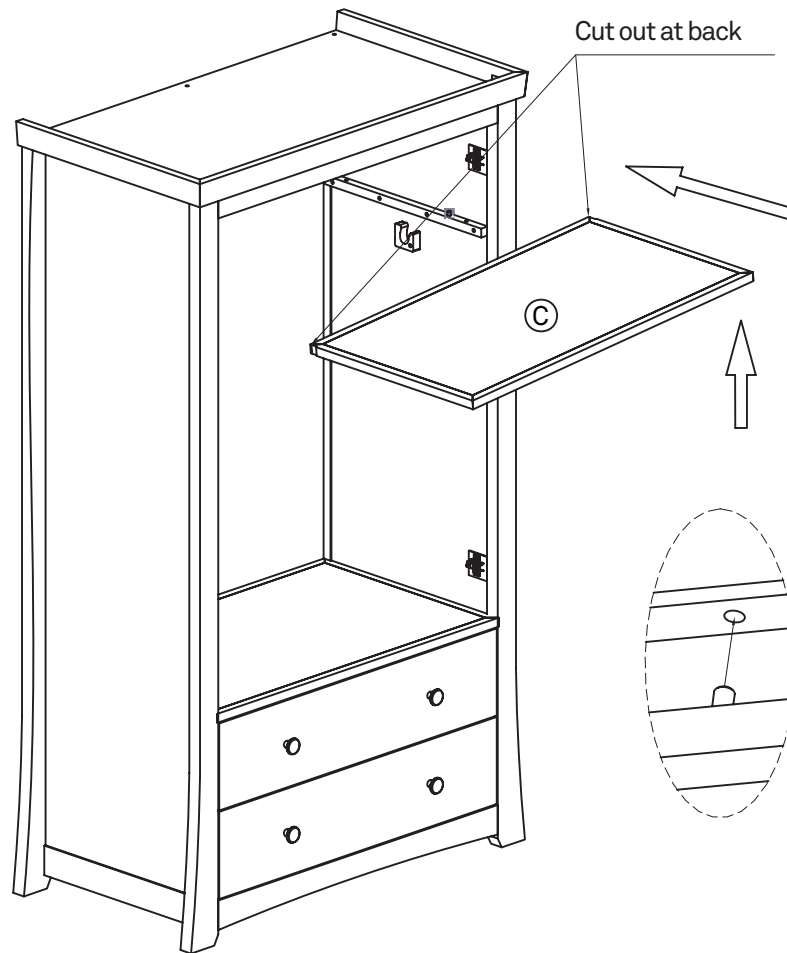

Step 6:

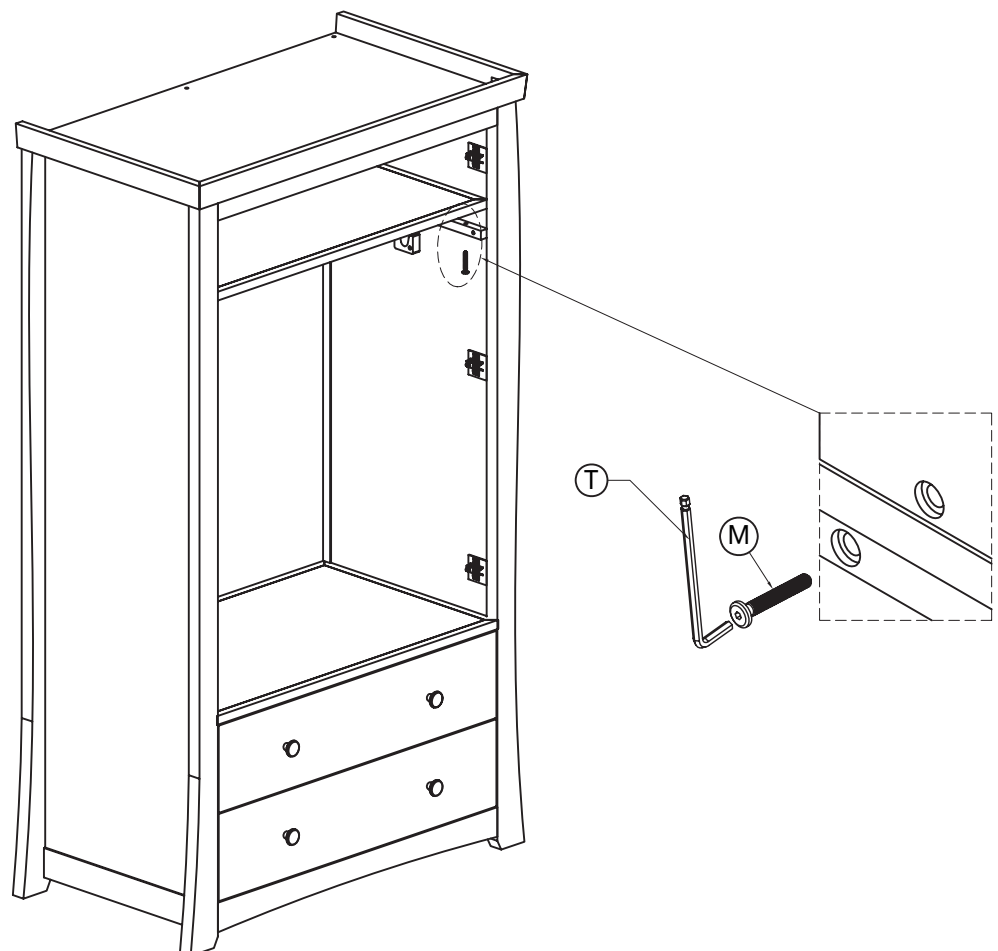

Step 7:

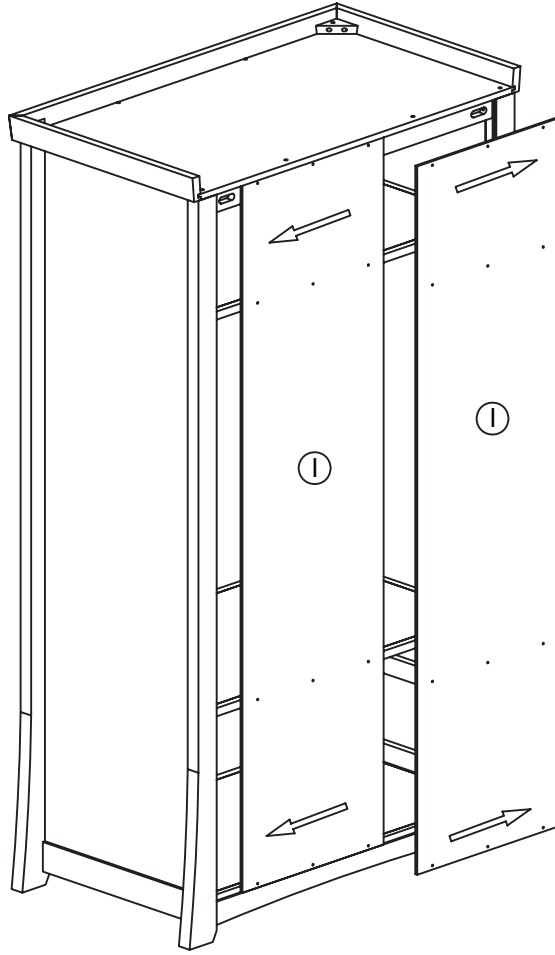

Step 8:

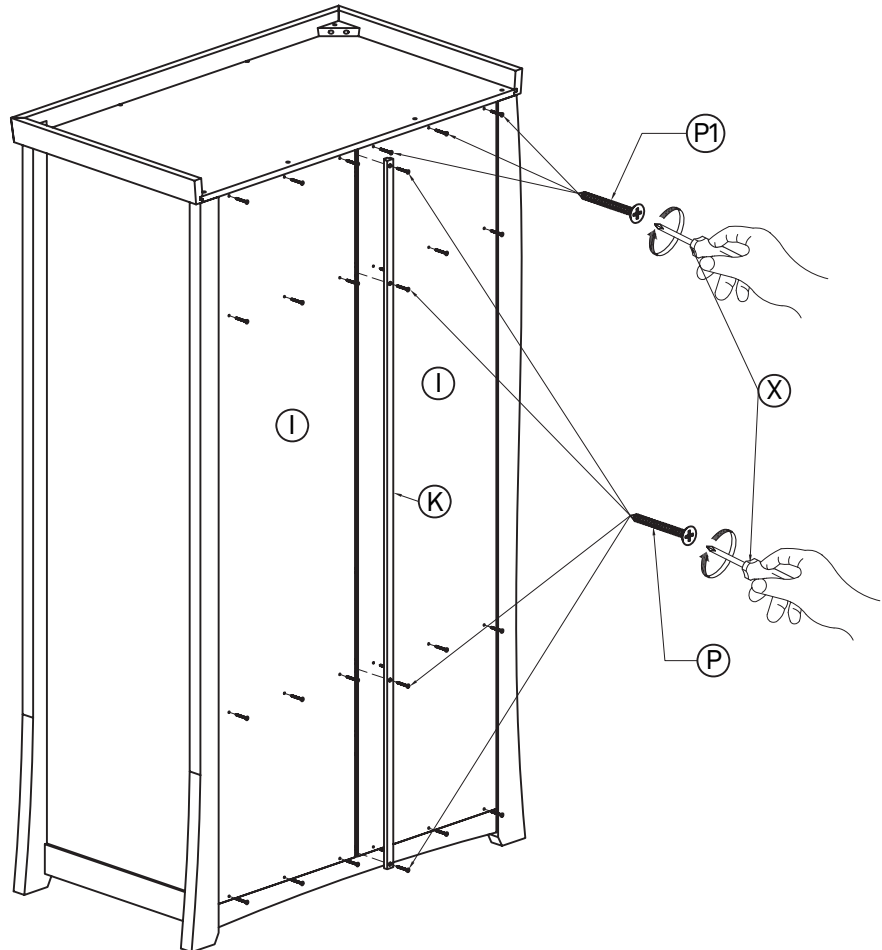

Step 9:

For both doors

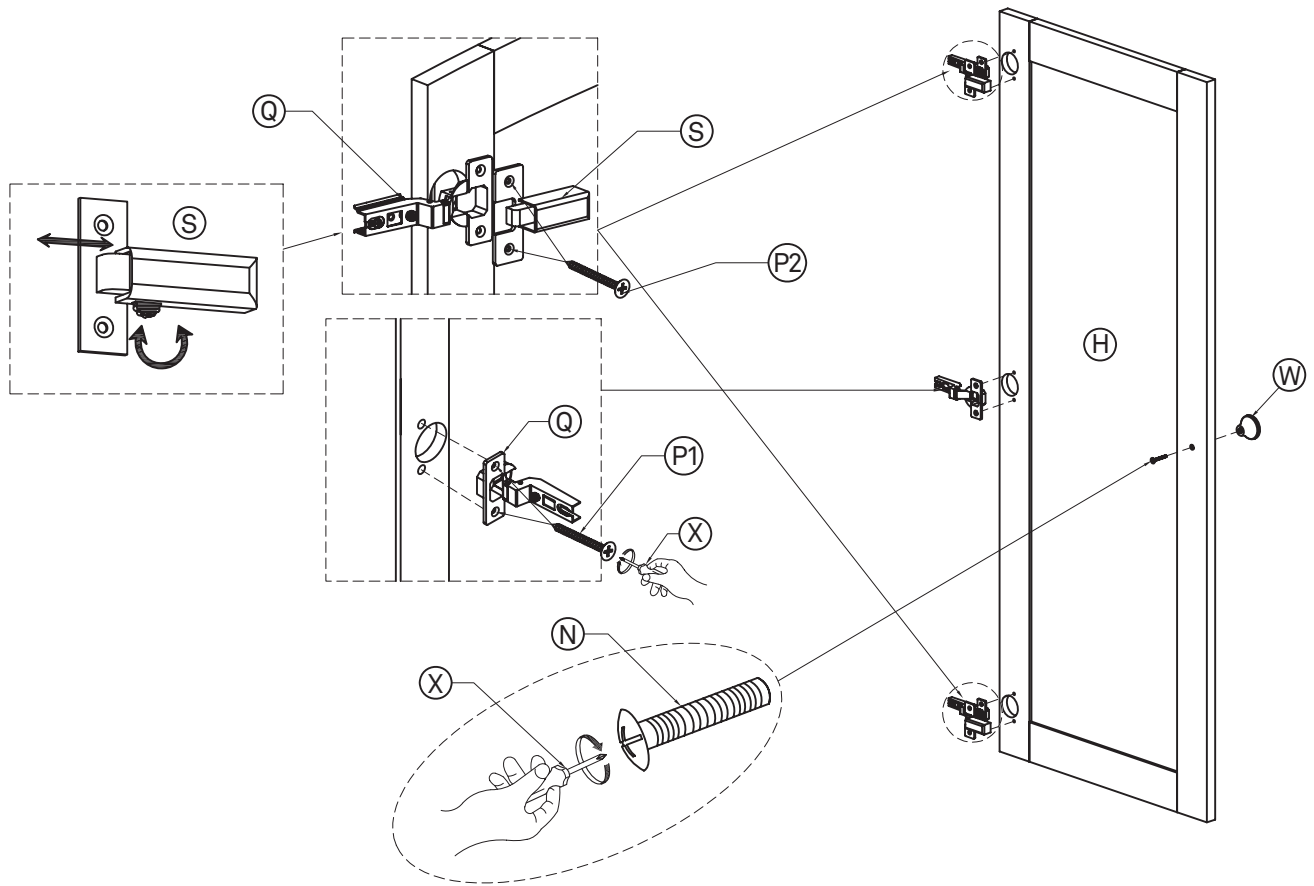

Step 10:

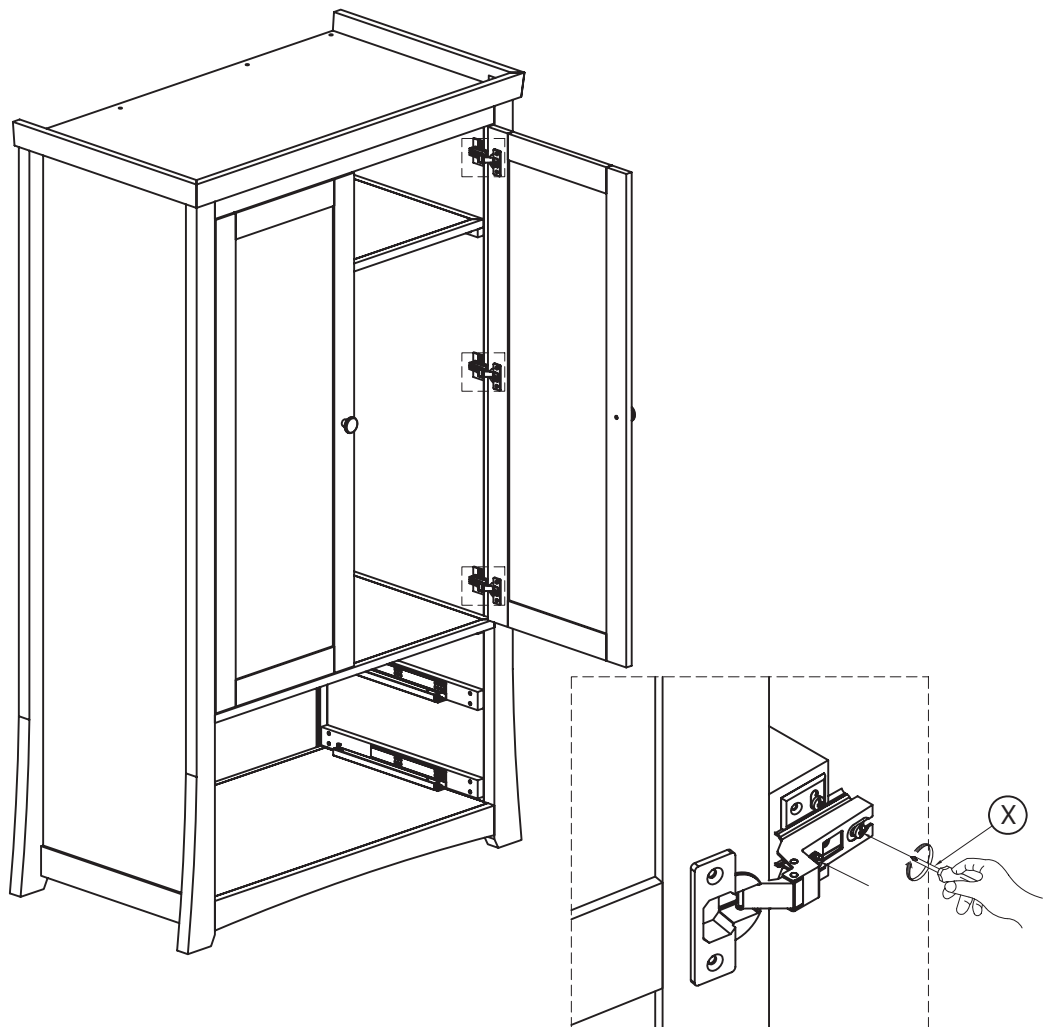

Step 11:

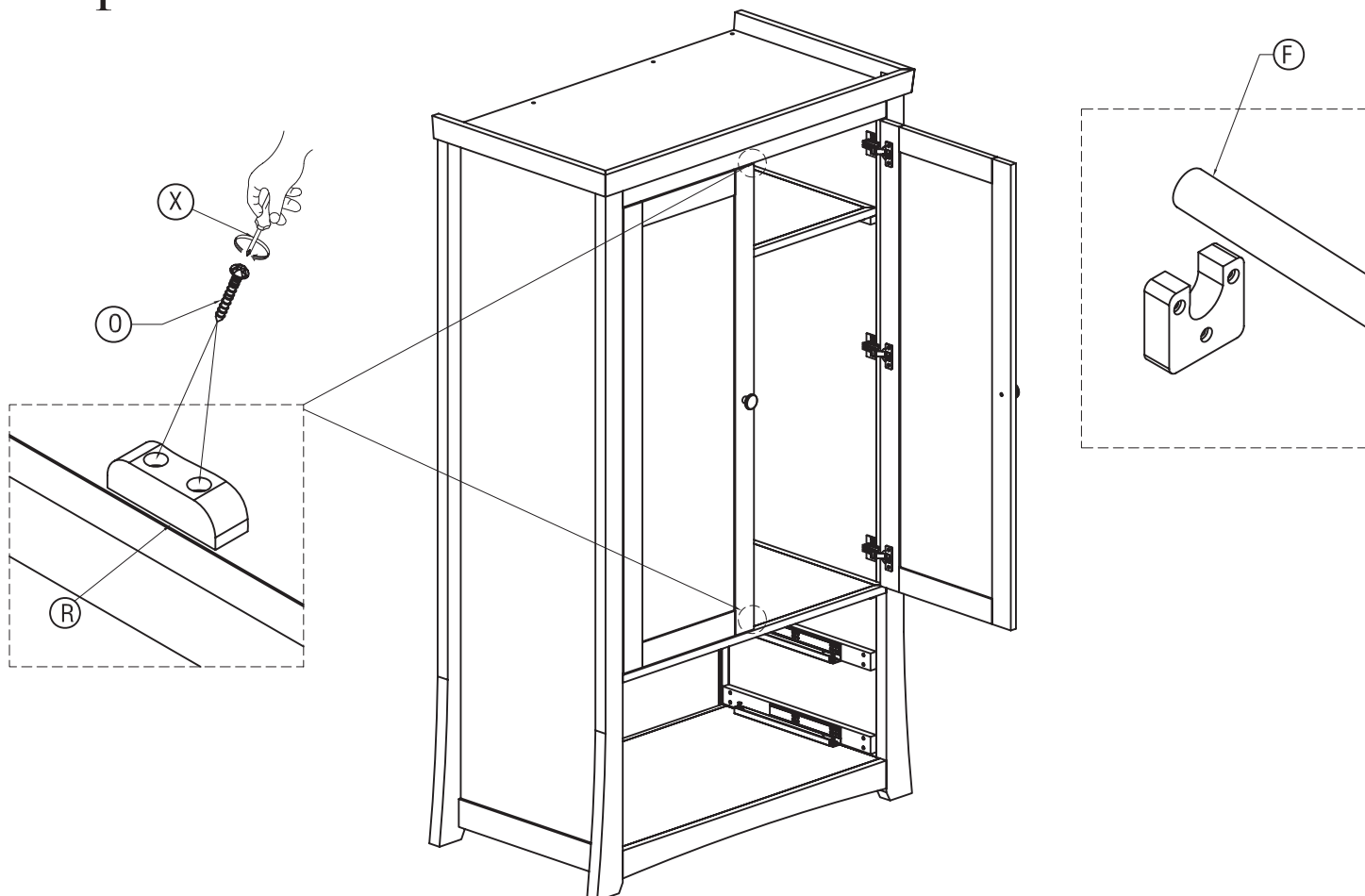

Step 12:

For both drawers

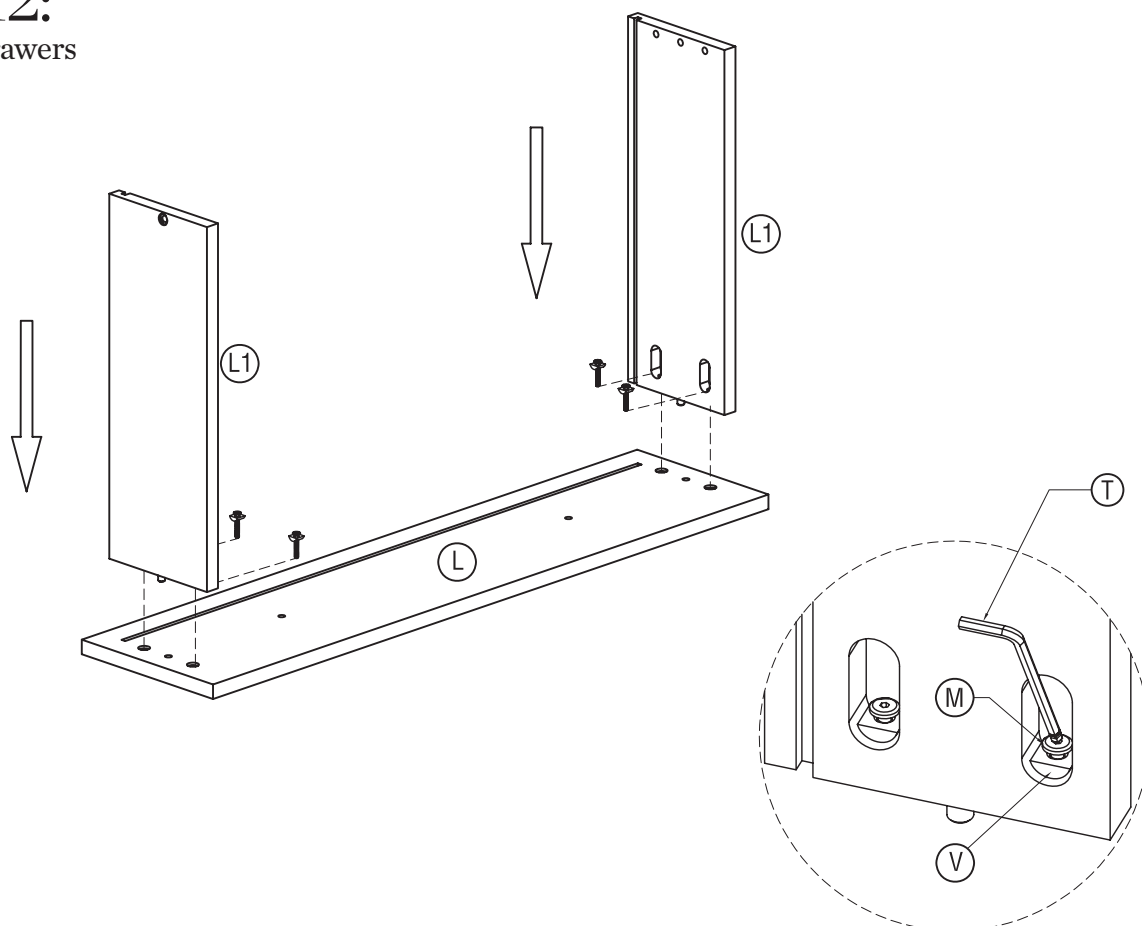

Step 13:

For both drawers

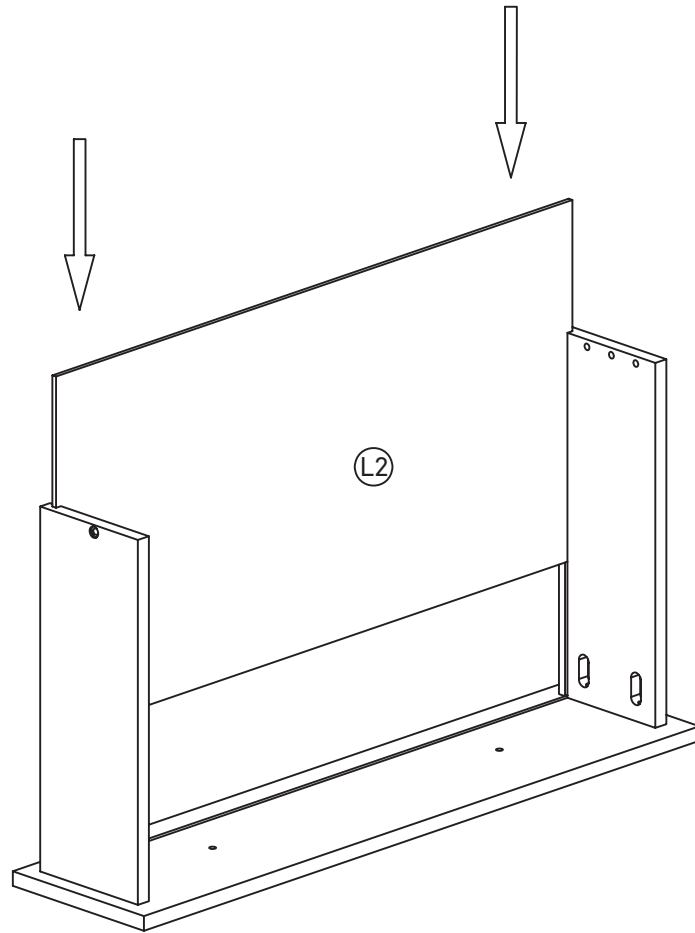

Step 14:

For both drawers

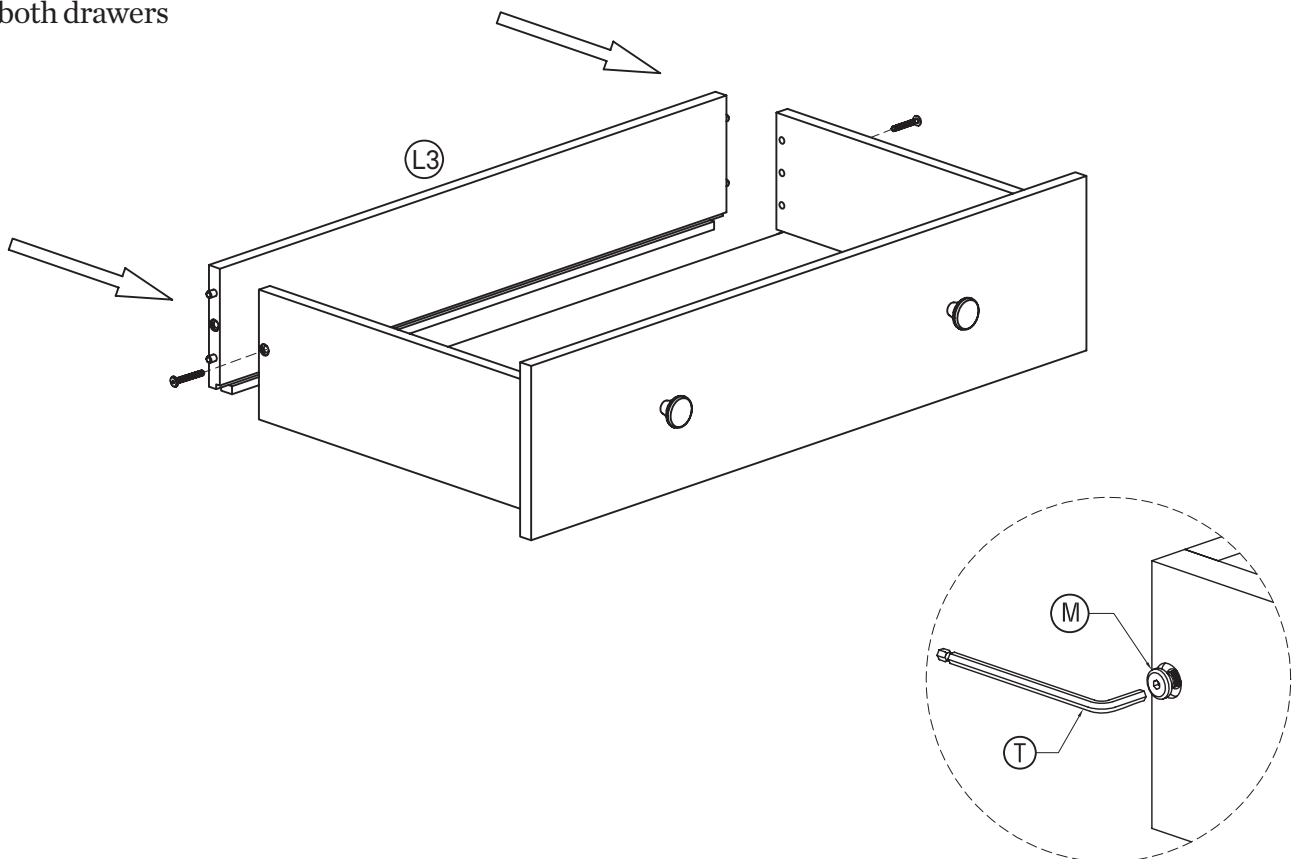

Step 15:

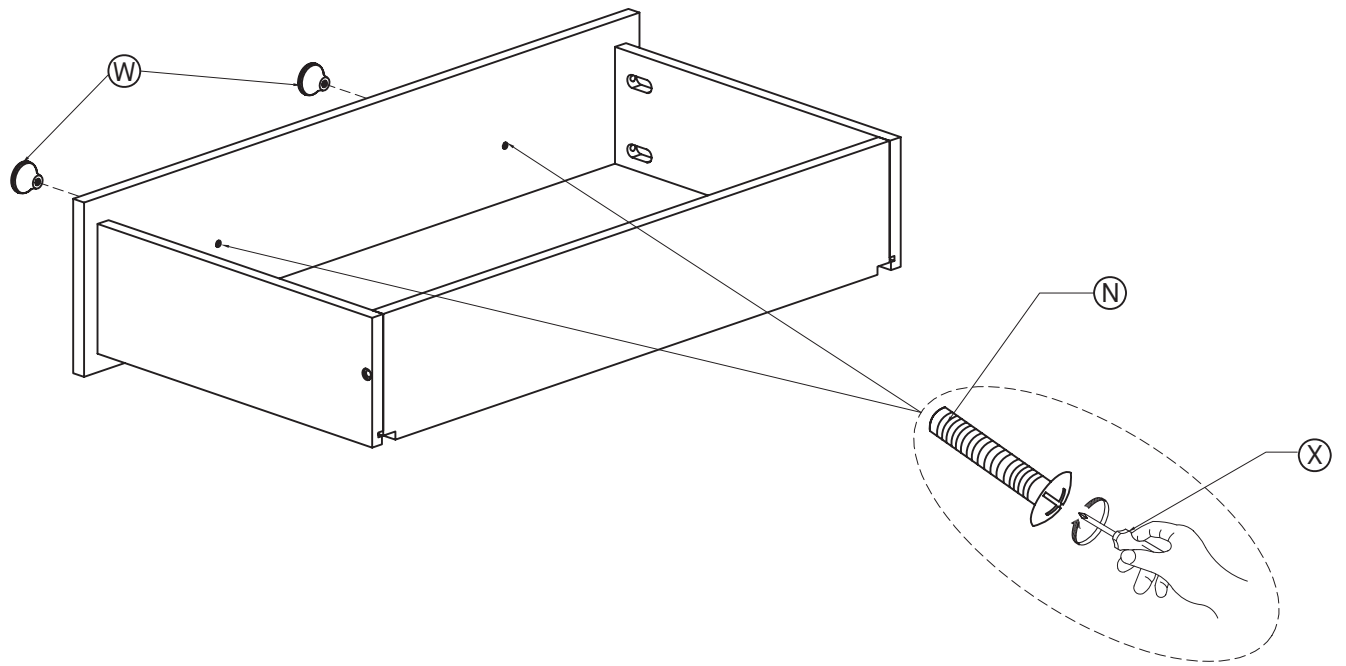

Step 16:

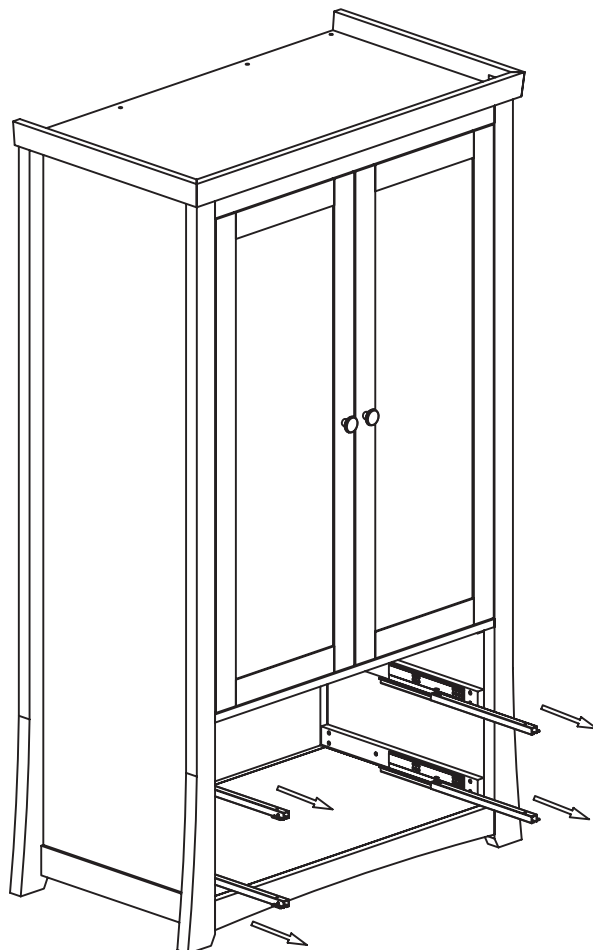

Step 17:

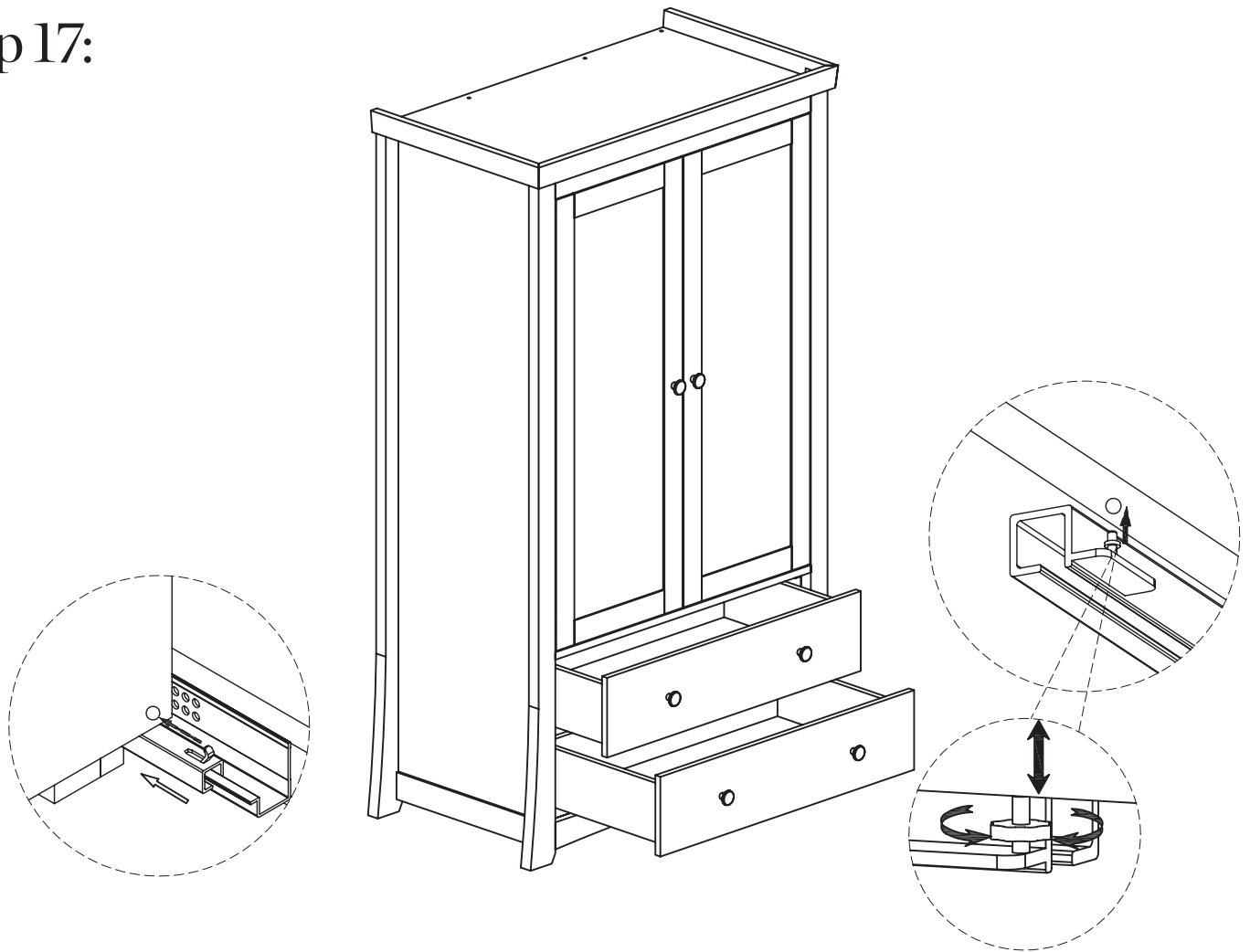

Step 18:

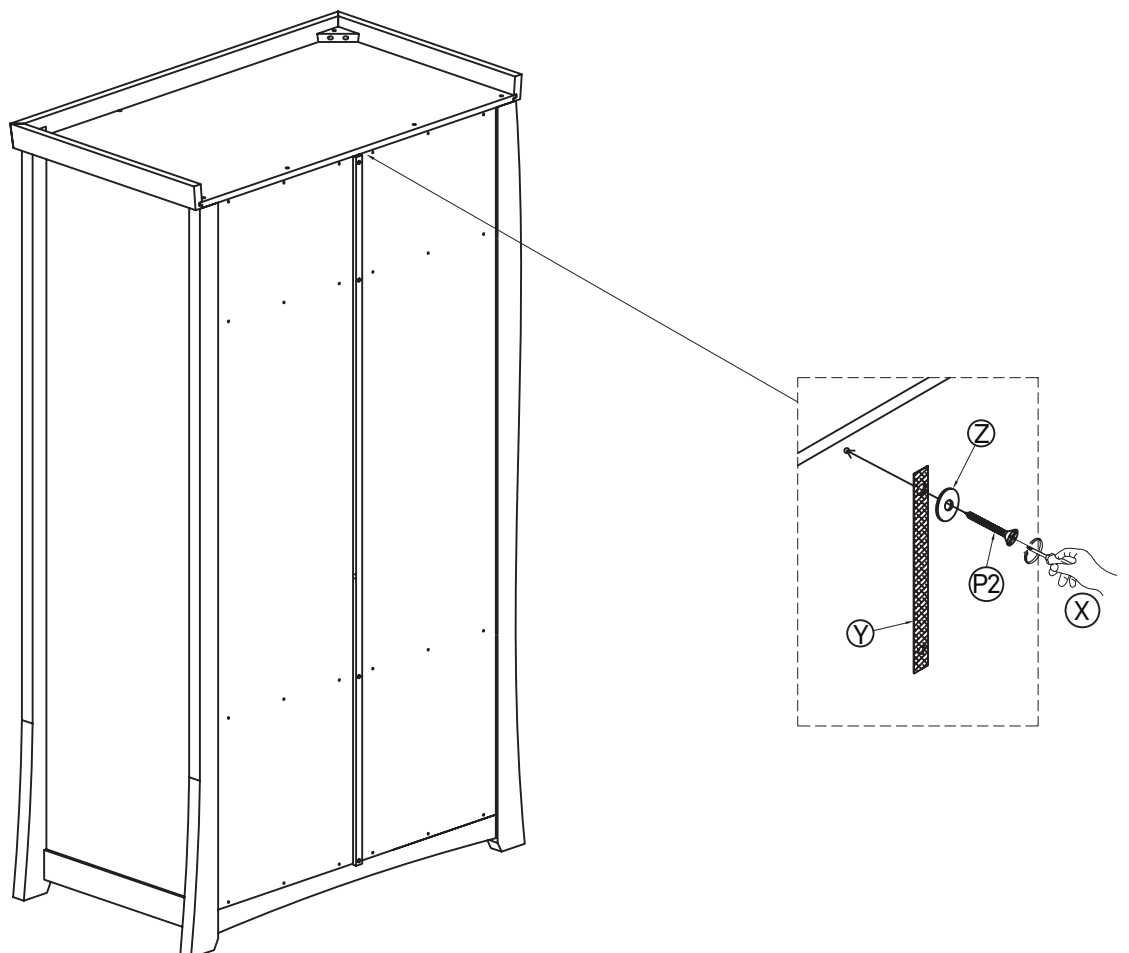

Step 19:

To convert wardrobe into full length hanging space by removing the top shelf

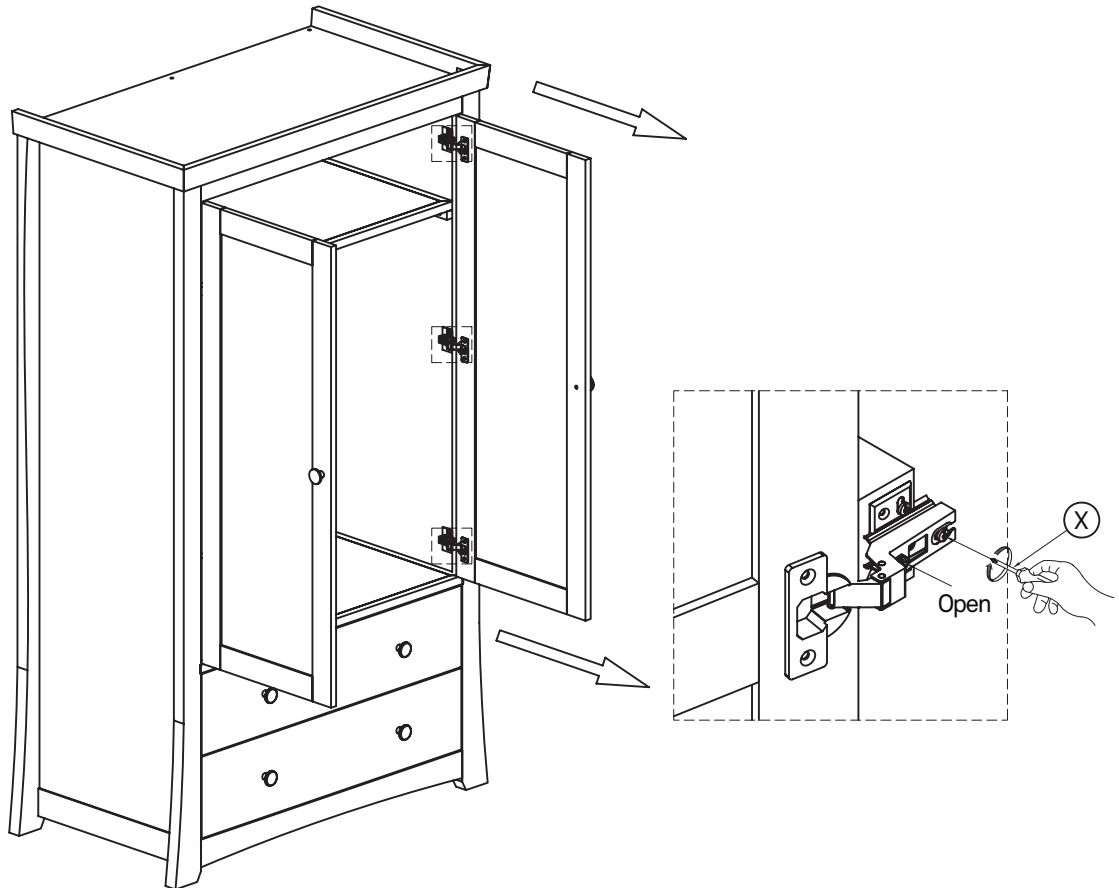

Step 20:

Remove 4 x retaining bolts (M) and remove 7 x back panel screws (6 x (P1) and 1 x (P))

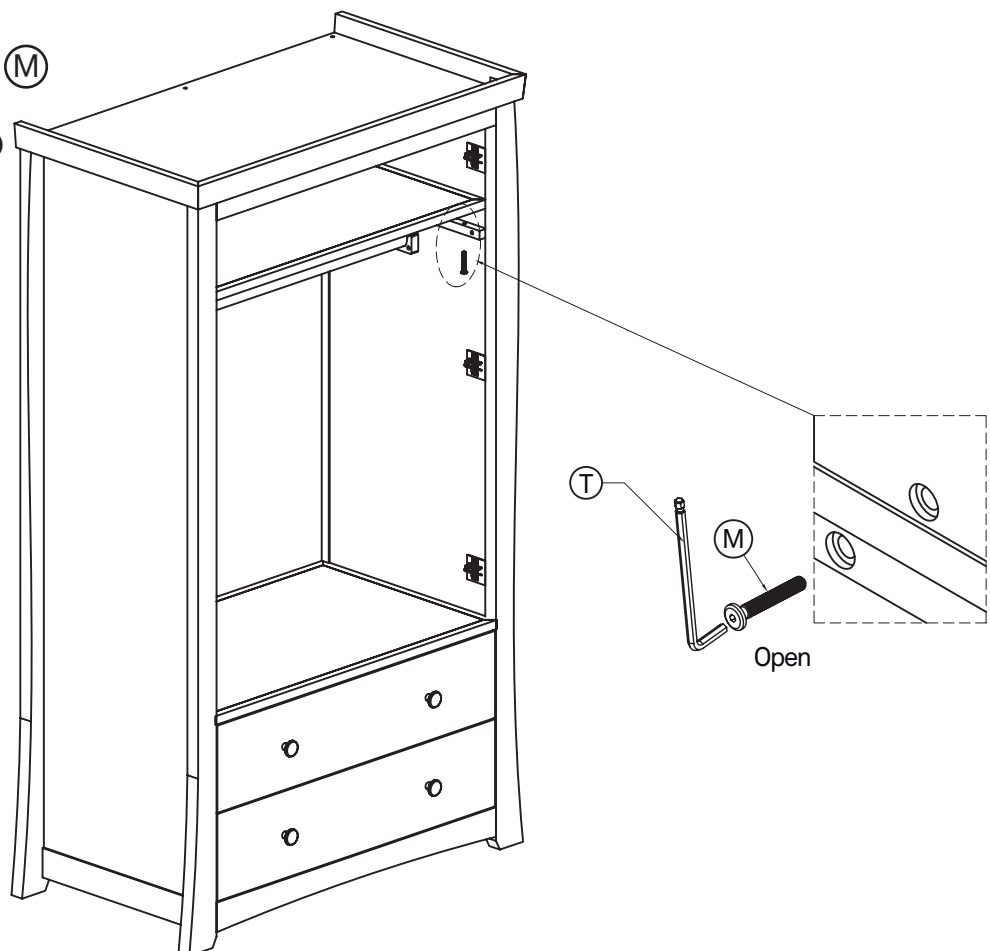

Step 21:

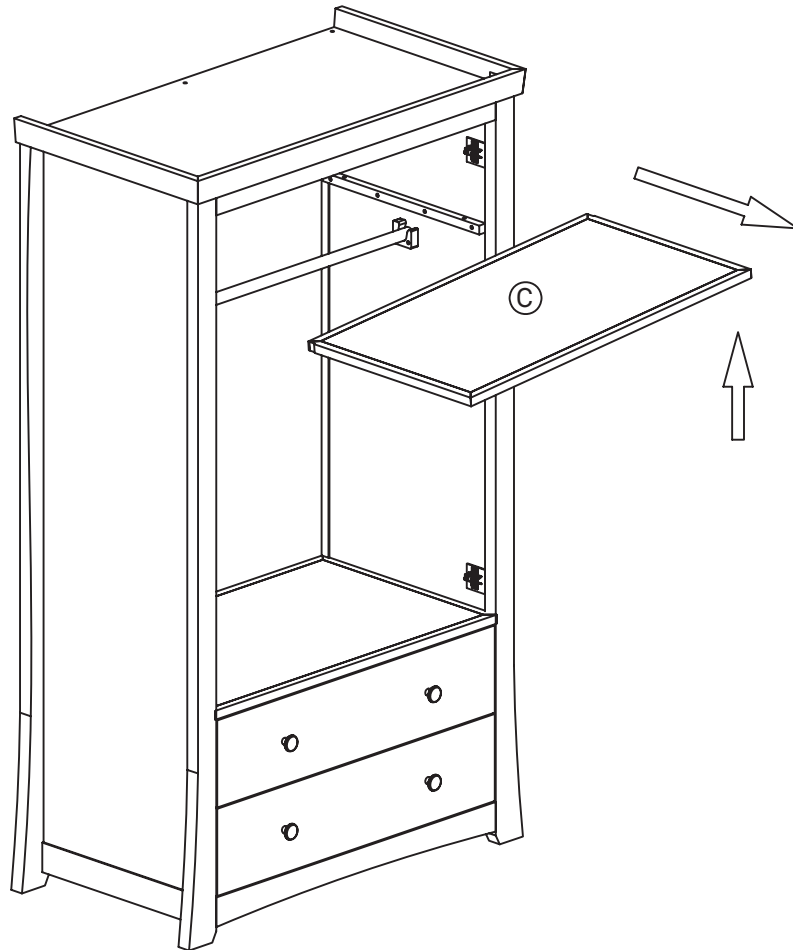

Step 22:

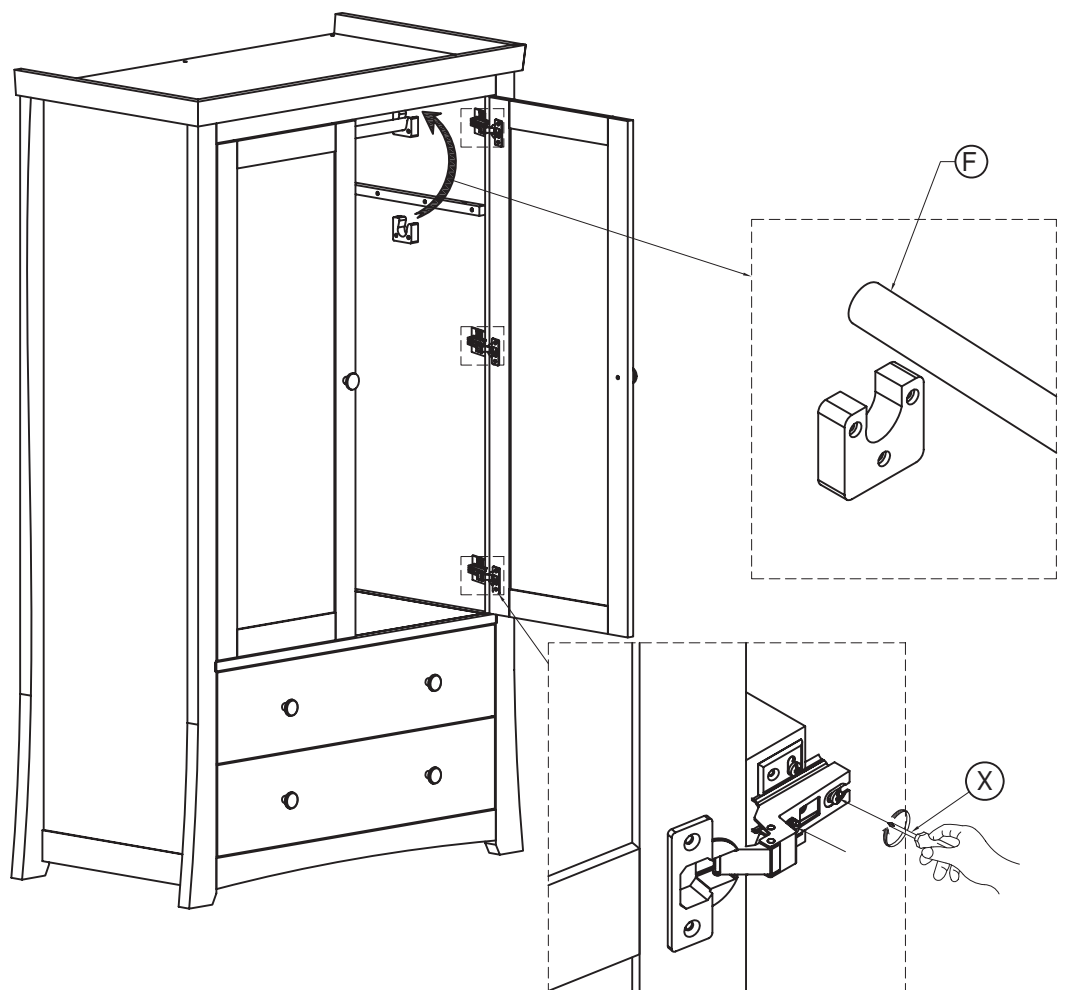

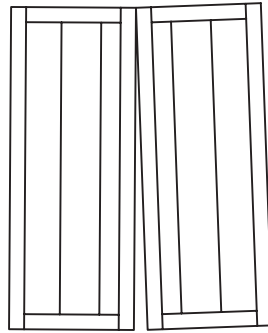
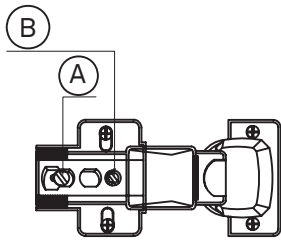

Adjusting the gap between the doors

Loosen screw "A", turn screw "B" clockwise or anti-clockwise until the gap between doors is equal then tighten screw "A".

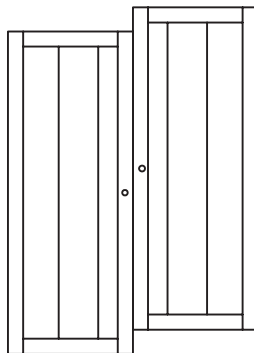
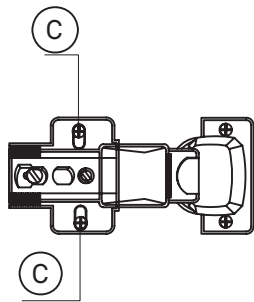

Adjusting the height of the doors

Loosen screws "C" then slide the hinge plate up or down until the doors are even, then tighten the screws. NOTE: The remaining two screws must be removed prior to adjustment

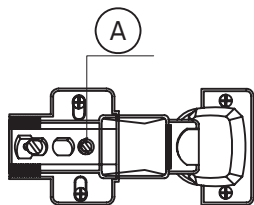

Adjusting the angle of the door

Loosen screw "A" and slide the hinge arm either forwards or backwards until the door is even vertical then tighten screw "A".

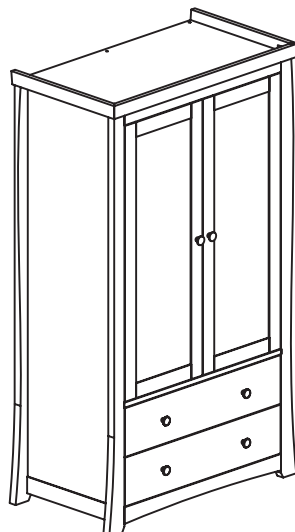

Notes:

Warnings & Instructions For Safe Use & Maintenance

WARNING

NEVER LEAVE YOUR CHILD UNATTENDED.

The safety of your child is your responsibility.

Regularly check all fittings and components are fully tightened and in good working order. If any parts have become worn or damaged then do not use the product and seek advice from your retailer or Silver Cross. Only use spare parts supplied by Silver Cross.

Be aware of the risk of open fire and other sources of strong heat, such as electric bar fires, gas fires etc. in the near vicinity of the wardrobe.

Never use the wardrobe if any parts are broken or missing.

Never drag or pivot the wardrobe. It must be lifted and moved by at least two people.

Before use, ensure the wardrobe is on a level, stable surface.

Do not allow children to climb on the wardrobe.

The wardrobe can be cleaned with a damp cloth. Never use bleach, abrasive or strong detergents. Thoroughly dry immediately after cleaning.

WALL STRAP INFORMATION

Never modify or change the wall strap in any way. Never use any other fittings other than those supplied to attach the wall strap to the wardrobe.

The wall strap provided is to be used with this product only.

Never use the screw provided to attach the strap to the wall. All walls are of different composition and it is important that the correct wall fittings are used. Consult a professional before attempting to attach the strap to the wall. No wall fittings are supplied with this product.

The wall strap must not be used to replace any other fittings supplied with this piece of furniture.

We recommend the wall strap is used in all cases. To improve the stability of the furniture an even wood or tiled floor is best. A carpeted or warped floor can enable the furniture to rock, increasing the potential of the furniture to fall over.

Silver Cross[®]